

GRADING & DRAINAGE NOTES:

- EXISTING PAVEMENT SHALL BE SAW-CUT AND PAVEMENT JOINT SHALL BE INSTALLED WHERE NECESSARY TO ENSURE A SMOOTH CONTINUOUS GRADE.
- ALL GRADING OPERATIONS SHALL BE COORDINATED WITH THE APPROPRIATE UTILITY COMPANIES.
- ALL AREAS DISTURBED DURING CONSTRUCTION SHALL BE STABILIZED AS SOON AS POSSIBLE UPON COMPLETION OF CONSTRUCTION WORK IN THE AREA.
- TEMPORARY TUBULAR BARRIER PROTECTION AND/OR SILT SACKS SHALL BE INSTALLED AND MAINTAINED AT EXISTING DRAINAGE STRUCTURES TO REMAIN DURING CONSTRUCTION, TO PREVENT SEDIMENT LADEN RUNOFF FROM ENTERING THE DRAINAGE SYSTEM.
- ALL CATCH BASINS, MANHOLES, INFILTRATION SYSTEMS, AND WATER QUALITY STRUCTURES ARE TO BE CLEANED TO REMOVE ALL CONSTRUCTION SILT AND DEBRIS PRIOR TO FINAL APPROVAL.
- IF ANY EXISTING UTILITY STRUCTURES TO REMAIN ARE DAMAGED DURING CONSTRUCTION, IT SHALL BE THE CONTRACTOR'S RESPONSIBILITY TO REPAIR AND/OR REPLACE THE EXISTING STRUCTURE AS NECESSARY TO RETURN IT TO EXISTING CONDITIONS OR BETTER AT NO ADDITIONAL COST.
- CONTRACTOR SHALL ENSURE POSITIVE DRAINAGE AWAY FROM BUILDINGS FOR ALL NATURAL AND PAVED AREAS.
- CONTRACTOR SHALL APPLY STABILIZATION FABRIC TO ALL SLOPES STEEPER THAN 3H:1V.

GENERAL NOTES:

- EXISTING CONDITIONS ARE BASED UPON PLAN ENTITLED "EXISTING CONDITIONS - 1381 CRANSTON STREET - CRANSTON, RI" AS PREPARED BY ALLEN & MAJOR ASSOCIATES, INC., DATED APRIL 11, 2022.
- THE CONTRACTOR IS SPECIFICALLY CAUTIONED THAT THE LOCATION AND/OR ELEVATION OF EXISTING UTILITIES AND STRUCTURES AS SHOWN ON THESE PLANS IS BASED ON RECORDS OF VARIOUS UTILITY COMPANIES AND WHERE POSSIBLE, MEASUREMENTS TAKEN IN THE FIELD. THIS INFORMATION IS NOT TO BE RELIED ON AS BEING EXACT OR COMPLETE. THE LOCATION OF ALL UNDERGROUND UTILITIES AND STRUCTURES SHALL BE VERIFIED IN THE FIELD BY THE CONTRACTOR PRIOR TO THE START OF CONSTRUCTION. THE CONTRACTOR MUST CONTACT THE APPROPRIATE UTILITY COMPANY, ANY GOVERNING PERMITTING AUTHORITY, AND "DIGSAFE" AT LEAST 72 HOURS PRIOR TO ANY EXCAVATION WORK TO REQUEST EXACT FIELD LOCATION OF UTILITIES AND THE ENGINEER SHALL BE NOTIFIED IN WRITING OF ANY UTILITIES INTERFERING WITH THE PROPOSED CONSTRUCTION AND APPROPRIATE REMEDIAL ACTION TAKEN BEFORE PROCEEDING WITH THE WORK. IT SHALL BE THE RESPONSIBILITY OF THE CONTRACTOR TO RELOCATE ALL EXISTING UTILITIES WHICH CONFLICT WITH THE PROPOSED IMPROVEMENTS SHOWN ON THE PLANS AT NO ADDITIONAL COST.
- THE CONTRACTOR IS RESPONSIBLE FOR OBTAINING ADDITIONAL BENCHMARK INFORMATION IF REQUIRED. THE CONTRACTOR IS RESPONSIBLE FOR LOCATING AND PROTECTING ALL EXISTING BENCHMARKS. IF IT IS NECESSARY TO RELOCATE A BENCHMARK, IT SHALL BE RELOCATED BY A RHODE ISLAND PROFESSIONAL LAND SURVEYOR AND DONE SO AT THE CONTRACTOR'S EXPENSE.
- CONTRACTOR SHALL BE RESPONSIBLE FOR ALL RELOCATIONS, INCLUDING BUT NOT LIMITED TO, ALL UTILITIES, STORM DRAINAGE, SIGNS, & POLES, ETC. AS REQUIRED. ALL WORK SHALL BE IN ACCORDANCE WITH THE LOCAL MUNICIPALITY'S GOVERNING AUTHORITY'S SPECIFICATIONS AND SHALL BE APPROVED BY SAME.
- THE CONTRACTOR SHALL COORDINATE WITH ALL UTILITY COMPANIES TO DETERMINE EXACT POINT OF SERVICE CONNECTION AND DISCONNECTION AT EXISTING UTILITY.

GENERAL NOTES:

- EXISTING CONDITIONS ARE BASED UPON PLAN ENTITLED "EXISTING CONDITIONS - 1381 CRANSTON STREET - CRANSTON, RI" AS PREPARED BY ALLEN & MAJOR ASSOCIATES, INC., DATED APRIL 11, 2022.
- THE CONTRACTOR IS SPECIFICALLY CAUTIONED THAT THE LOCATION AND/OR ELEVATION OF EXISTING UTILITIES AND STRUCTURES AS SHOWN ON THESE PLANS IS BASED ON RECORDS OF VARIOUS UTILITY COMPANIES AND WHERE POSSIBLE, MEASUREMENTS TAKEN IN THE FIELD. THIS INFORMATION IS NOT TO BE RELIED ON AS BEING EXACT OR COMPLETE. THE LOCATION OF ALL UNDERGROUND UTILITIES AND STRUCTURES SHALL BE VERIFIED IN THE FIELD BY THE CONTRACTOR PRIOR TO THE START OF CONSTRUCTION. THE CONTRACTOR MUST CONTACT THE APPROPRIATE UTILITY COMPANY, ANY GOVERNING PERMITTING AUTHORITY, AND "DIGSAFE" AT LEAST 72 HOURS PRIOR TO ANY EXCAVATION WORK TO REQUEST EXACT FIELD LOCATION OF UTILITIES AND THE ENGINEER SHALL BE NOTIFIED IN WRITING OF ANY UTILITIES INTERFERING WITH THE PROPOSED CONSTRUCTION AND APPROPRIATE REMEDIAL ACTION TAKEN BEFORE PROCEEDING WITH THE WORK. IT SHALL BE THE RESPONSIBILITY OF THE CONTRACTOR TO RELOCATE ALL EXISTING UTILITIES WHICH CONFLICT WITH THE PROPOSED IMPROVEMENTS SHOWN ON THE PLANS AT NO ADDITIONAL COST.
- THE CONTRACTOR IS RESPONSIBLE FOR OBTAINING ADDITIONAL BENCHMARK INFORMATION IF REQUIRED. THE CONTRACTOR IS RESPONSIBLE FOR LOCATING AND PROTECTING ALL EXISTING BENCHMARKS. IF IT IS NECESSARY TO RELOCATE A BENCHMARK, IT SHALL BE RELOCATED BY A RHODE ISLAND PROFESSIONAL LAND SURVEYOR AND DONE SO AT THE CONTRACTOR'S EXPENSE.
- CONTRACTOR SHALL BE RESPONSIBLE FOR ALL RELOCATIONS, INCLUDING BUT NOT LIMITED TO, ALL UTILITIES, STORM DRAINAGE, SIGNS, & POLES, ETC. AS REQUIRED. ALL WORK SHALL BE IN ACCORDANCE WITH THE LOCAL MUNICIPALITY'S GOVERNING AUTHORITY'S SPECIFICATIONS AND SHALL BE APPROVED BY SAME.
- THE CONTRACTOR SHALL COORDINATE WITH ALL UTILITY COMPANIES TO DETERMINE EXACT POINT OF SERVICE CONNECTION AND DISCONNECTION AT EXISTING UTILITY.

LEGEND

- DRAIN MANHOLE
- CATCH BASIN
- CATCH BASIN - DOUBLE GRATE
- OUTLET CONTROL
- DIVERSION WEIR
- WATER QUALITY UNIT
- AREA DRAIN
- FLARED END SECTION
- DRAIN LINE
- RIPRAP OUTFALL
- HEADWALL
- 5' CONTOUR
- 1' CONTOUR
- SPOT GRADE
- INFILTRATION SYSTEM
- INFILTRATION PIPE
- DETENTION PIPE
- UNDERDRAIN
- FLOW DIRECTION

BRIAN D. JONES
No. 11089
REGISTERED PROFESSIONAL ENGINEER
CIVIL

Brian D. Jones
01-25-23

PROFESSIONAL ENGINEER FOR ALLEN & MAJOR ASSOCIATES, INC.

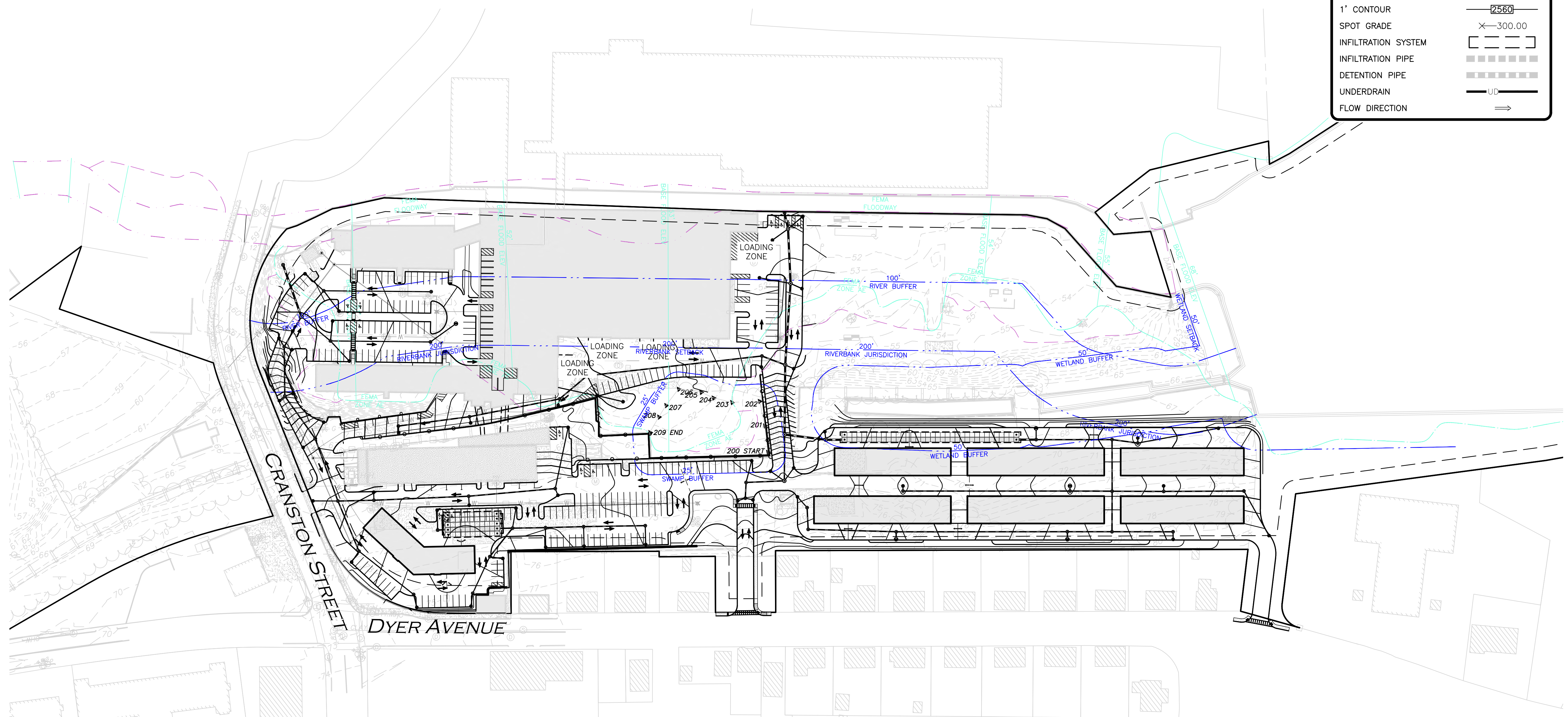

DIG SAFE

BEFORE YOU DIG
CALL 811 OR
1-888-DIG-SAFE
1-888-344-7233

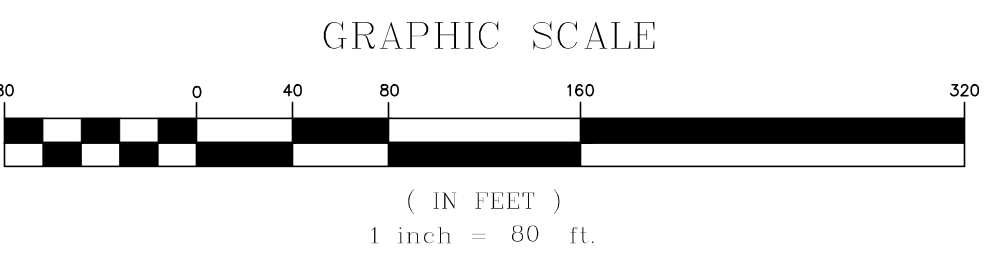

R:\PROJECTS\2038-08\CIVIL\DRAWINGS\CURRENT\2038-08_GRADING & DRAINAGE.DWG

REV	DATE	DESCRIPTION

APPLICANT/OWNER:
CPW TRUE STORAGE LLC
670 N. COMMERCIAL STREET, SUITE 303
MANCHESTER, NH 03101

PROJECT:
SITE REDEVELOPMENT
ASSESSORS MAP 8, LOTS 195, 1617 & 2711
1381 CRANSTON STREET - CRANSTON, RI

PROJECT NO.	2038-08	DATE:	01-25-2023
SCALE:	1" = 80'	DWG.:	C2038-08_GRADING & DRAINAGE
DESIGNED BY:	JRG	CHECKED BY:	MAM

ALLEN & MAJOR ASSOCIATES, INC.

civil engineering • land surveying
environmental consulting • landscape architecture
www.allenmajor.com
100 COMMERCE WAY, SUITE 5
WOBURN MA 01801
TEL: (781) 935-6889
FAX: (781) 935-2896

WOBURN, MA • LAKEVILLE, MA • MANCHESTER, NH

THIS DRAWING HAS BEEN PREPARED IN DIGITAL FORMAT. CLIENT/CLIENTS REPRESENTATIVE OR CONSULTANTS MAY BE PROVIDED COPIES OF DRAWINGS AND SPECIFICATIONS FOR HIS/HER INFORMATION AND/OR SPECIFIC USE ON THIS PROJECT. DUE TO THE POTENTIAL THAT THE PROVIDED INFORMATION MAY BE MODIFIED UNINTENTIONALLY OR OTHERWISE, ALLEN & MAJOR ASSOCIATES, INC. MAY REMOVE ALL INDICATION OF THE DOCUMENT'S AUTHORSHIP ON THE DIGITAL MEDIA. PRINTED REPRESENTATIONS OR PORTABLE DOCUMENT FORMAT OF THE DRAWINGS AND SPECIFICATIONS ISSUED SHALL BE THE ONLY RECORD COPIES OF ALLEN & MAJOR ASSOCIATES, INC.'S WORK PRODUCT.

DRAWING TITLE:	SHEET No.
GRADING & DRAINAGE PLAN	C-103

Copyright © 2022 Allen & Major Associates, Inc.
All Rights Reserved

R:\PROJECTS\2038-08\CIVIL\DRAWINGS\CURRENT\C-2038-08_GRADING & DRAINAGE.DWG

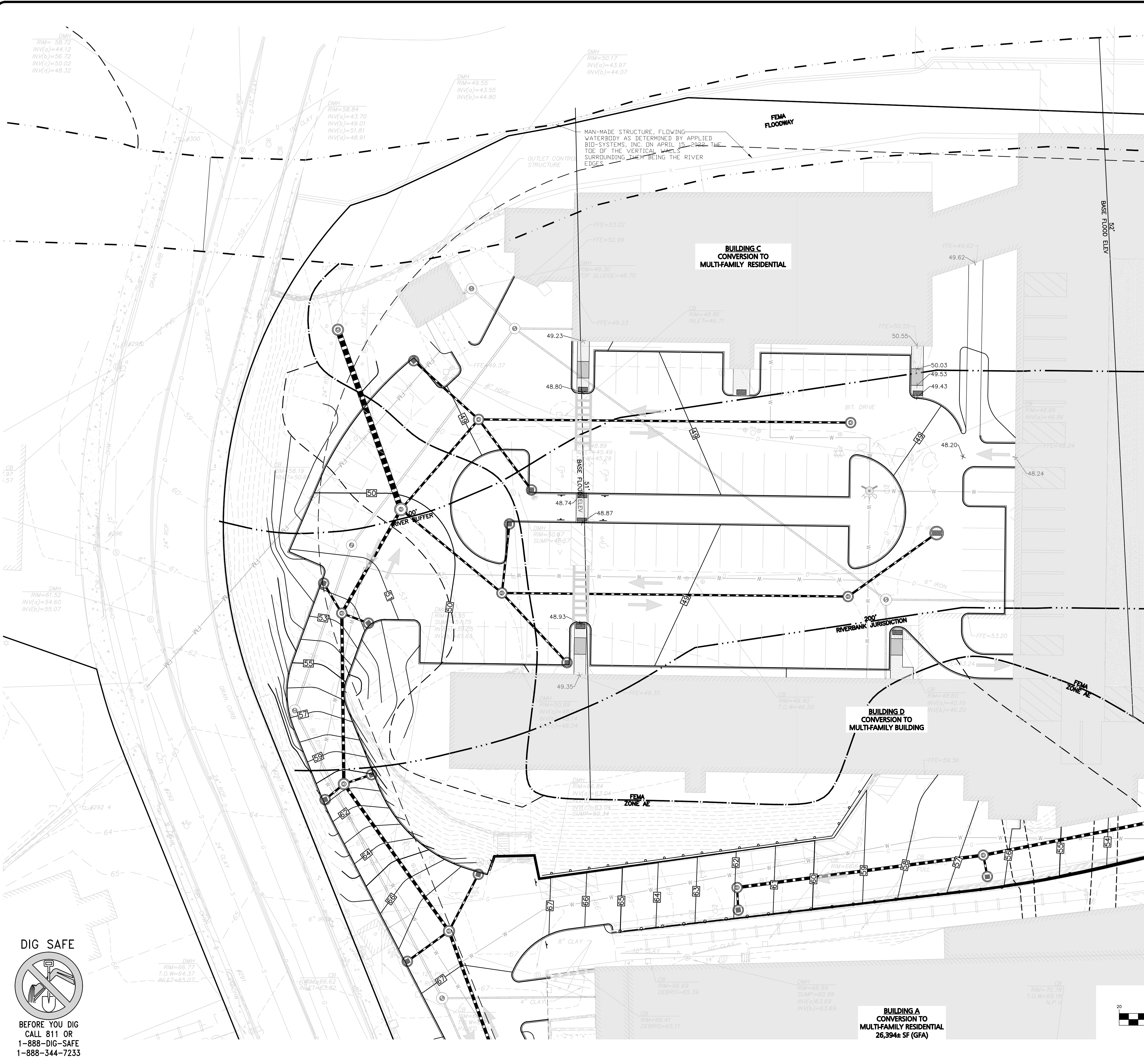

LEGEND

- DRAIN MANHOLE
- CATCH BASIN
- CATCH BASIN - DOUBLE GRATE
- OUTLET CONTROL
- DIVERSION WEIR
- WATER QUALITY UNIT
- AREA DRAIN
- FLARED END SECTION
- DRAIN LINE
- RIPRAP OUTFALL
- HEADWALL
- 5' CONTOUR
- 1' CONTOUR
- SPOT GRADE
- INFILTRATION SYSTEM
- INFILTRATION PIPE
- DETENTION PIPE
- UNDERDRAIN
- FLOW DIRECTION

- ### GENERAL NOTES:
- REFER TO SHEET C-102 FOR ADDITIONAL COMPLIANCE INFORMATION.
 - ALL CONSTRUCTION SHALL CONFORM TO THE APPLICABLE REGULATIONS AND STANDARDS INCLUDING THE TOWN OF CRANSTON, RIDOT, RIDEP, MUTCD, AND AASHTO.
 - THE CONTRACTOR IS SOLELY RESPONSIBLE FOR THE MEANS AND METHODS OF CONSTRUCTION AND FOR CONDITIONS AT THE SITE. THESE PLANS, PREPARED BY ALLEN & MAJOR ASSOCIATES DO NOT EXTEND TO OR INCLUDE SYSTEMS PERTAINING TO THE SAFETY OF THE CONSTRUCTION CONTRACTOR OR THEIR EMPLOYEES, AGENTS OR REPRESENTATIVES IN THE PERFORMANCE OF THE WORK, OR THE OWNER'S EMPLOYEES, CUSTOMERS, OR THE GENERAL PUBLIC. THE SEAL OF THE ENGINEER AS INCLUDED IN THE PLAN SET DOES NOT EXTEND TO ANY SUCH SAFETY SYSTEMS THAT MAY NOW OR HEREAFTER BE INCORPORATED INTO THESE PLANS. THE CONSTRUCTION CONTRACTOR SHALL PROVIDE THE APPROPRIATE SAFETY SYSTEMS WHICH MAY BE REQUIRED BY THE
 - ALL ELEVATIONS REFER TO NAVD 88.
 - THE CONTRACTOR SHALL ADHERE TO ALL TERMS & CONDITIONS AS OUTLINED IN THE GENERAL N.P.D.E.S. PERMIT FOR STORMWATER DISCHARGE ASSOCIATED WITH CONSTRUCTION ACTIVITIES.
 - IT IS THE RESPONSIBILITY OF THE CONTRACTOR TO REVIEW ALL DRAWINGS AND SPECIFICATIONS ASSOCIATED WITH THE PROJECT WORK SCOPE PRIOR TO THE START OF CONSTRUCTION. SHOULD THE CONTRACTOR FIND A CONFLICT WITH THE DRAWINGS, SPECIFICATIONS, OR RELATIVE CODES, IT IS THE RESPONSIBILITY OF THE CONTRACTOR TO NOTIFY THE ENGINEER AND/OR ARCHITECT PRIOR TO START OF CONSTRUCTION. FAILURE BY THE CONTRACTOR TO NOTIFY THE ENGINEER AND/OR ARCHITECT SHALL CONSTITUTE ACCEPTANCE OF FULL RESPONSIBILITY BY THE CONTRACTOR TO COMPLETE THE SCOPE OF WORK AND/OR DESIGN INTENT OF THE DRAWINGS AND IN FULL COMPLIANCE WITH LOCAL REGULATIONS AND CODES.
 - THE DESIGN ENGINEER WAIVES ANY AND ALL RESPONSIBILITY AND LIABILITY FOR PROBLEMS WHICH ARISE FROM FAILURE TO FOLLOW THESE PLANS, SPECIFICATIONS, AND/OR THE DESIGN INTENT THEY CONVEY, OR FOR PROBLEMS WHICH ARISE FROM OTHERS' FAILURE TO OBTAIN AND/OR FOLLOW THE GUIDANCE OF THE DESIGN ENGINEER WITH RESPECT TO ANY ERRORS, OMISSIONS, INCONSISTENCIES, AMBIGUITIES, OR CONFLICTS WHICH ARE DISCOVERED OR ALLEGED.

BRIAN D. JONES
 No. 11089
 REGISTERED PROFESSIONAL ENGINEER CIVIL
Brian D. Jones
 01-25-23

PROFESSIONAL ENGINEER FOR ALLEN & MAJOR ASSOCIATES, INC.

CPW TRUE STORAGE LLC
 670 N. COMMERCIAL STREET, SUITE 303
 MANCHESTER, NH 03101

SITE REDEVELOPMENT
 ASSESSORS MAP 8, LOTS 195, 1617 & 2711
 1381 CRANSTON STREET - CRANSTON, RI

PROJECT NO. 2038-08 DATE: 01-25-2023
 SCALE: 1" = 20' DWG.: C2038-08_GRADING & DRAINAGE
 DESIGNED BY: JRG CHECKED BY: MAM

ALLEN & MAJOR ASSOCIATES, INC.
 civil engineering • land surveying
 environmental consulting • landscape architecture
 www.allenmajor.com
 100 COMMERCE WAY, SUITE 5
 WOBURN MA 01801
 TEL: (781) 935-6889
 FAX: (781) 935-2896

THIS DRAWING HAS BEEN PREPARED IN DIGITAL FORMAT. CLIENTS/CLIENTS' REPRESENTATIVE OR CONSULTANTS MAY BE PROVIDED COPIES OF DRAWINGS AND SPECIFICATIONS FOR HIS/HER INFORMATION AND/OR SPECIFIC USE ON THIS PROJECT. DUE TO THE POTENTIAL THAT THE PROVIDED INFORMATION MAY BE MODIFIED UNINTENTIONALLY OR OTHERWISE, ALLEN & MAJOR ASSOCIATES, INC. MAY REMOVE ALL INDICATION OF THE DOCUMENT'S AUTHORSHIP ON THE DIGITAL MEDIA. PRINTED REPRESENTATIONS OR PORTABLE DOCUMENT FORMAT OF THE DRAWINGS AND SPECIFICATIONS ISSUED SHALL BE THE ONLY RECORD COPIES OF ALLEN & MAJOR ASSOCIATES, INC.'S WORK PRODUCT.

DRAWING TITLE: GRADING & DRAINAGE PLAN C-103A
 SHEET No.

DIG SAFE

 BEFORE YOU DIG
 CALL 811 OR
 1-888-DIG-SAFE
 1-888-344-7233

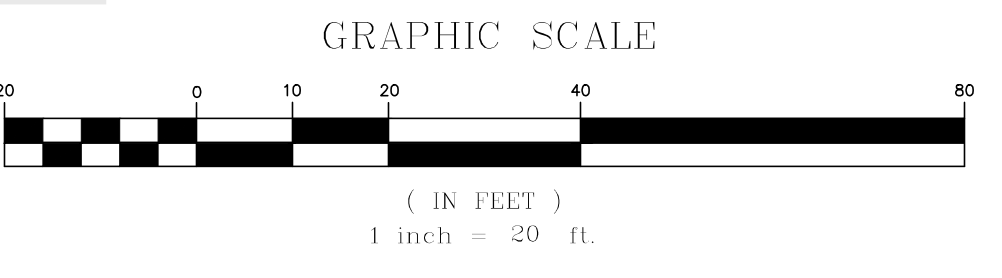

BUILDING A
 CONVERSION TO
 MULTI-FAMILY RESIDENTIAL
 26,394± SF (GFA)

BUILDING D
 CONVERSION TO
 MULTI-FAMILY BUILDING

BUILDING C
 CONVERSION TO
 MULTI-FAMILY RESIDENTIAL

R:\PROJECTS\2038-08\CIVIL\DRAWINGS\CURRENT\2038-08_GRADING & DRAINAGE.DWG

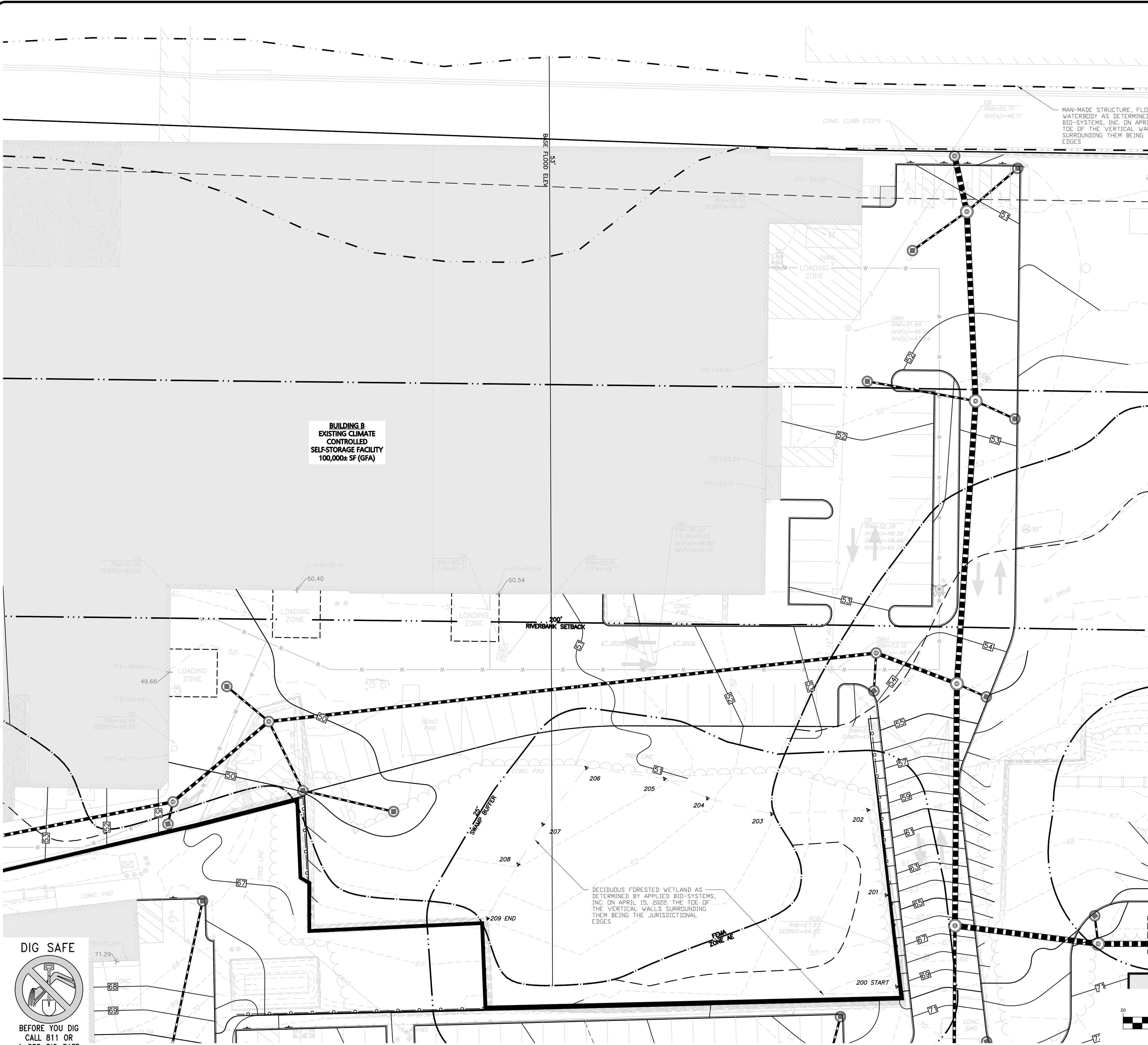

LEGEND

- DRAIN MANHOLE
- CATCH BASIN
- CATCH BASIN - DOUBLE GRATE
- OUTLET CONTROL
- DIVERSION WEIR
- WATER QUALITY UNIT
- AREA DRAIN
- FLARED END SECTION
- DRAIN LINE
- RIPRAP OUTFALL
- HEADWALL
- 5' CONTOUR
- 1' CONTOUR
- SPOT GRADE
- INFILTRATION SYSTEM
- INFILTRATION PIPE
- DETENTION PIPE
- UNDERDRAIN
- FLOW DIRECTION

- ### GENERAL NOTES:
- REFER TO SHEET C-102 FOR ADDITIONAL COMPLIANCE INFORMATION.
 - ALL CONSTRUCTION SHALL CONFORM TO THE APPLICABLE REGULATIONS AND STANDARDS INCLUDING THE TOWN OF CRANSTON, RIDOT, RIDEP, MUTCD, AND AASHTO.
 - THE CONTRACTOR IS SOLELY RESPONSIBLE FOR THE MEANS AND METHODS OF CONSTRUCTION AND FOR CONDITIONS AT THE SITE. THESE PLANS, PREPARED BY ALLEN & MAJOR ASSOCIATES DO NOT EXTEND TO OR INCLUDE SYSTEMS PERTAINING TO THE SAFETY OF THE CONSTRUCTION CONTRACTOR OR THEIR EMPLOYEES, AGENTS OR REPRESENTATIVES IN THE PERFORMANCE OF THE WORK, OR THE OWNER'S EMPLOYEES, CUSTOMERS, OR THE GENERAL PUBLIC. THE SEAL OF THE ENGINEER AS INCLUDED IN THE PLAN SET DOES NOT EXTEND TO ANY SUCH SAFETY SYSTEMS THAT MAY NOW OR HEREAFTER BE INCORPORATED INTO THESE PLANS. THE CONSTRUCTION CONTRACTOR SHALL PROVIDE THE APPROPRIATE SAFETY SYSTEMS WHICH MAY BE REQUIRED BY THE.
 - ALL ELEVATIONS REFER TO NAVD 88.
 - THE CONTRACTOR SHALL ADHERE TO ALL TERMS & CONDITIONS AS OUTLINED IN THE GENERAL N.P.D.E.S. PERMIT FOR STORMWATER DISCHARGE ASSOCIATED WITH CONSTRUCTION ACTIVITIES.
 - IT IS THE RESPONSIBILITY OF THE CONTRACTOR TO REVIEW ALL DRAWINGS AND SPECIFICATIONS ASSOCIATED WITH THE PROJECT WORK SCOPE PRIOR TO THE START OF CONSTRUCTION. SHOULD THE CONTRACTOR FIND A CONFLICT WITH THE DRAWINGS, SPECIFICATIONS, OR RELATIVE CODES, IT IS THE RESPONSIBILITY OF THE CONTRACTOR TO NOTIFY THE ENGINEER AND/OR ARCHITECT PRIOR TO START OF CONSTRUCTION. FAILURE BY THE CONTRACTOR TO NOTIFY THE ENGINEER AND/OR ARCHITECT SHALL CONSTITUTE ACCEPTANCE OF FULL RESPONSIBILITY BY THE CONTRACTOR TO COMPLETE THE SCOPE OF WORK AND/OR DESIGN INTENT OF THE DRAWINGS AND IN FULL COMPLIANCE WITH LOCAL REGULATIONS AND CODES.
 - THE DESIGN ENGINEER WAIVES ANY AND ALL RESPONSIBILITY AND LIABILITY FOR PROBLEMS WHICH ARISE FROM FAILURE TO FOLLOW THESE PLANS, SPECIFICATIONS, AND/OR THE DESIGN INTENT THEY CONVEY, OR FOR PROBLEMS WHICH ARISE FROM OTHERS' FAILURE TO OBTAIN AND/OR FOLLOW THE GUIDANCE OF THE DESIGN ENGINEER WITH RESPECT TO ANY ERRORS, OMISSIONS, INCONSISTENCIES, AMBIGUITIES, OR CONFLICTS WHICH ARE DISCOVERED OR ALLEGED.

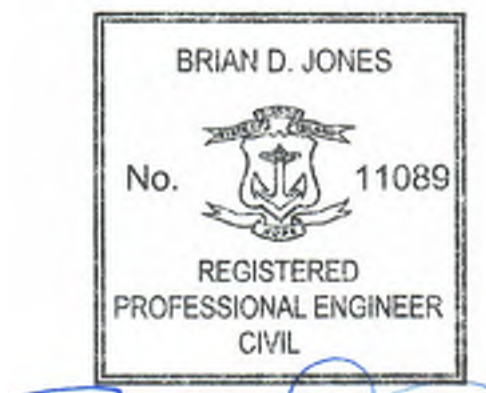

Brian D. Jones
01-25-23

PROFESSIONAL ENGINEER FOR
ALLEN & MAJOR ASSOCIATES, INC.

REV	DATE	DESCRIPTION

APPLICANT/OWNER:
CPW TRUE STORAGE LLC
670 N. COMMERCIAL STREET, SUITE 303
MANCHESTER, NH 03101

PROJECT:
SITE REDEVELOPMENT
ASSESSORS MAP 8, LOTS 195, 1617 & 2711
1381 CRANSTON STREET - CRANSTON, RI

PROJECT NO. 2038-08 DATE: 01-25-2023

SCALE: 1" = 20' DWG.: C2038-08_GRADING & DRAINAGE

DESIGNED BY: JRG CHECKED BY: MAM

PREPARED BY:

ALLEN & MAJOR ASSOCIATES, INC.
civil engineering • land surveying
environmental consulting • landscape architecture
www.allenmajor.com
100 COMMERCE WAY, SUITE 5
WOUBURN MA 01801
TEL: (781) 935-6889
FAX: (781) 935-2896

WOUBURN, MA • LAKEVILLE, MA • MANCHESTER, NH

THIS DRAWING HAS BEEN PREPARED IN DIGITAL FORMAT. CLIENT/CLIENTS REPRESENTATIVE OR CONSULTANTS MAY BE PROVIDED COPIES OF DRAWINGS AND SPECIFICATIONS FOR HIS/HER INFORMATION AND/OR SPECIFIC USE ON THIS PROJECT. DUE TO THE POTENTIAL THAT THE PROVIDED INFORMATION MAY BE MODIFIED UNINTENTIONALLY OR OTHERWISE, ALLEN & MAJOR ASSOCIATES, INC. MAY REMOVE ALL INDICATION OF THE DOCUMENT'S AUTHORSHIP ON THE DIGITAL MEDIA. PRINTED REPRESENTATIONS OR PORTABLE DOCUMENT FORMAT OF THE DRAWINGS AND SPECIFICATIONS ISSUED SHALL BE THE ONLY RECORD COPIES OF ALLEN & MAJOR ASSOCIATES, INC.'S WORK PRODUCT.

DRAWING TITLE: GRADING & DRAINAGE PLAN SHEET No. C-103B

Copyright © 2022 Allen & Major Associates, Inc. All Rights Reserved

DIG SAFE
BEFORE YOU DIG
CALL 811 OR
1-888-DIG-SAFE
1-888-344-7233

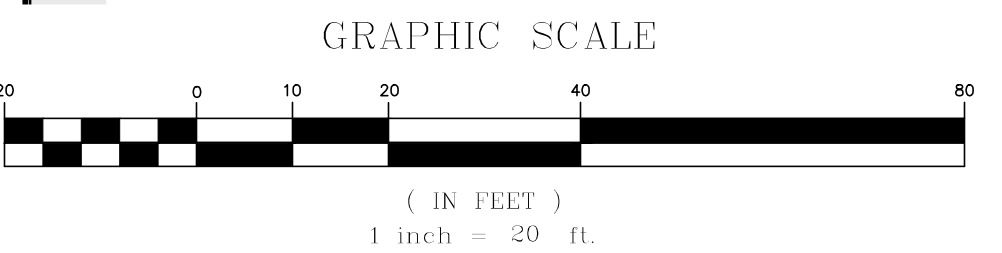

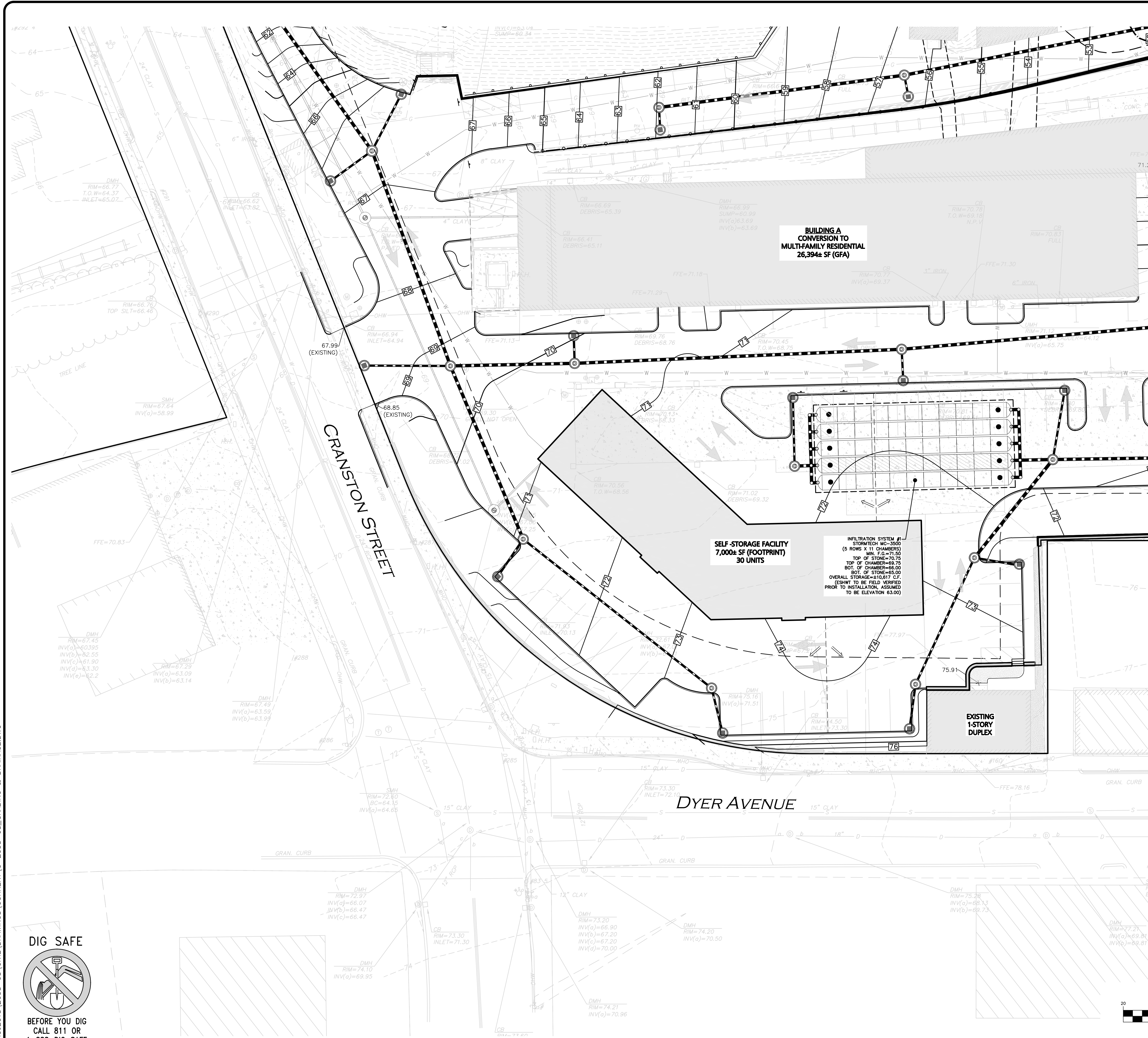

LEGEND

- DRAIN MANHOLE
- CATCH BASIN
- CATCH BASIN - DOUBLE GRATE
- OUTLET CONTROL
- DIVERSION WEIR
- WATER QUALITY UNIT
- AREA DRAIN
- FLARED END SECTION
- DRAIN LINE
- RIPRAP OFFFALL
- HEADWALL
- 5' CONTOUR
- 1' CONTOUR
- SPOT GRADE
- INFILTRATION SYSTEM
- INFILTRATION PIPE
- DETENTION PIPE
- UNDERDRAIN
- FLOW DIRECTION

- ### GENERAL NOTES:
- REFER TO SHEET C-102 FOR ADDITIONAL COMPLIANCE INFORMATION.
 - ALL CONSTRUCTION SHALL CONFORM TO THE APPLICABLE REGULATIONS AND STANDARDS INCLUDING THE TOWN OF CRANSTON, RIDOT, RIDEP, MUTCD, AND AASHTO.
 - THE CONTRACTOR IS SOLELY RESPONSIBLE FOR THE MEANS AND METHODS OF CONSTRUCTION AND FOR CONDITIONS AT THE SITE. THESE PLANS, PREPARED BY ALLEN & MAJOR ASSOCIATES DO NOT EXTEND TO OR INCLUDE SYSTEMS PERTAINING TO THE SAFETY OF THE CONSTRUCTION CONTRACTOR OR THEIR EMPLOYEES, AGENTS OR REPRESENTATIVES IN THE PERFORMANCE OF THE WORK, OR THE OWNER'S EMPLOYEES, CUSTOMERS, OR THE GENERAL PUBLIC. THE SEAL OF THE ENGINEER AS INCLUDED IN THE PLAN SET DOES NOT EXTEND TO ANY SUCH SAFETY SYSTEMS THAT MAY NOW OR HEREAFTER BE INCORPORATED INTO THESE PLANS. THE CONSTRUCTION CONTRACTOR SHALL PROVIDE THE APPROPRIATE SAFETY SYSTEMS WHICH MAY BE REQUIRED BY THE
 - ALL ELEVATIONS REFER TO NAVD 88.
 - THE CONTRACTOR SHALL ADHERE TO ALL TERMS & CONDITIONS AS OUTLINED IN THE GENERAL N.P.D.E.S. PERMIT FOR STORMWATER DISCHARGE ASSOCIATED WITH CONSTRUCTION ACTIVITIES.
 - IT IS THE RESPONSIBILITY OF THE CONTRACTOR TO REVIEW ALL DRAWINGS AND SPECIFICATIONS ASSOCIATED WITH THE PROJECT WORK SCOPE PRIOR TO THE START OF CONSTRUCTION. SHOULD THE CONTRACTOR FIND A CONFLICT WITH THE DRAWINGS, SPECIFICATIONS, OR RELATIVE CODES, IT IS THE RESPONSIBILITY OF THE CONTRACTOR TO NOTIFY THE ENGINEER AND/OR ARCHITECT PRIOR TO START OF CONSTRUCTION. FAILURE BY THE CONTRACTOR TO NOTIFY THE ENGINEER AND/OR ARCHITECT SHALL CONSTITUTE ACCEPTANCE OF FULL RESPONSIBILITY BY THE CONTRACTOR TO COMPLETE THE SCOPE OF WORK AND/OR DESIGN INTENT OF THE DRAWINGS AND IN FULL COMPLIANCE WITH LOCAL REGULATIONS AND CODES.
 - THE DESIGN ENGINEER WAIVES ANY AND ALL RESPONSIBILITY AND LIABILITY FOR PROBLEMS WHICH ARISE FROM FAILURE TO FOLLOW THESE PLANS, SPECIFICATIONS, AND/OR THE DESIGN INTENT THEY CONVEY, OR FOR PROBLEMS WHICH ARISE FROM OTHERS' FAILURE TO OBTAIN AND/OR FOLLOW THE GUIDANCE OF THE DESIGN ENGINEER WITH RESPECT TO ANY ERRORS, OMISSIONS, INCONSISTENCIES, AMBIGUITIES, OR CONFLICTS WHICH ARE DISCOVERED OR ALLEGED.

BRIAN D. JONES
 No. 11089
 REGISTERED PROFESSIONAL ENGINEER CIVIL

B. Jones
 01-25-23

PROFESSIONAL ENGINEER FOR ALLEN & MAJOR ASSOCIATES, INC.

REV DATE DESCRIPTION

APPLICANT/OWNER:
 CPW TRUE STORAGE LLC
 670 N. COMMERCIAL STREET, SUITE 303
 MANCHESTER, NH 03101

PROJECT:
 SITE REDEVELOPMENT
 ASSESSORS MAP 8, LOTS 195, 1617 & 2711
 1381 CRANSTON STREET - CRANSTON, RI

PROJECT NO. 2038-08 DATE: 01-25-2023
 SCALE: 1" = 20' DWG.: C2038-08 GRADING & DRAINAGE
 DESIGNED BY: JRG CHECKED BY: MAM

PREPARED BY:

ALLEN & MAJOR ASSOCIATES, INC.
 civil engineering • land surveying
 environmental consulting • landscape architecture
 www.allenmajor.com
 100 COMMERCE WAY, SUITE 5
 WOBURN MA 01801
 TEL: (781) 935-6889
 FAX: (781) 935-2896

WOBURN, MA • LAKEVILLE, MA • MANCHESTER, NH

THIS DRAWING HAS BEEN PREPARED IN DIGITAL FORMAT. CLIENT/CUSTOMER REPRESENTATIVE OR CONSULTANTS MAY BE PROVIDED COPIES OF DRAWINGS AND SPECIFICATIONS FOR HIS/HER INFORMATION AND/OR SPECIFIC USE ON THIS PROJECT. DUE TO THE POTENTIAL THAT THE PROVIDED INFORMATION MAY BE MODIFIED UNINTENTIONALLY OR OTHERWISE, ALLEN & MAJOR ASSOCIATES, INC. MAY REMOVE ALL INDICATION OF THE DOCUMENT'S AUTHORSHIP ON THE DIGITAL MEDIA. PRINTED REPRESENTATIONS OR PORTABLE DOCUMENT FORMAT OF THE DRAWINGS AND SPECIFICATIONS ISSUED SHALL BE THE ONLY RECORD COPIES OF ALLEN & MAJOR ASSOCIATES, INC.'S WORK PRODUCT.

DRAWING TITLE: GRADING & DRAINAGE PLAN SHEET No. C-103C

Copyright © 2022 Allen & Major Associates, Inc. All Rights Reserved.

R:\PROJECTS\2038-08\CIVIL\DRAWINGS\CURRENT\C-2038-08 GRADING & DRAINAGE.DWG

DIG SAFE

BEFORE YOU DIG
 CALL 811 OR
 1-888-DIG-SAFE
 1-888-344-7233

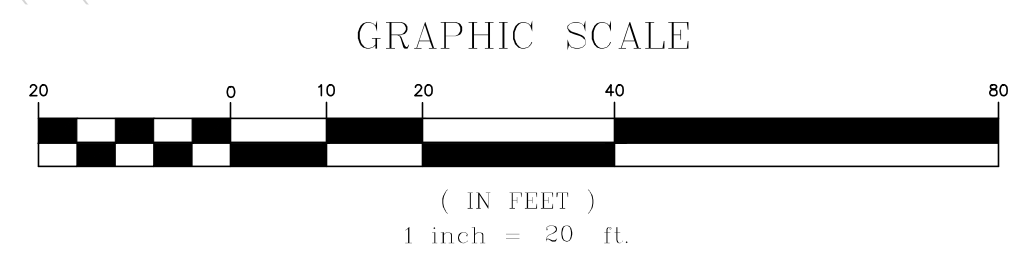

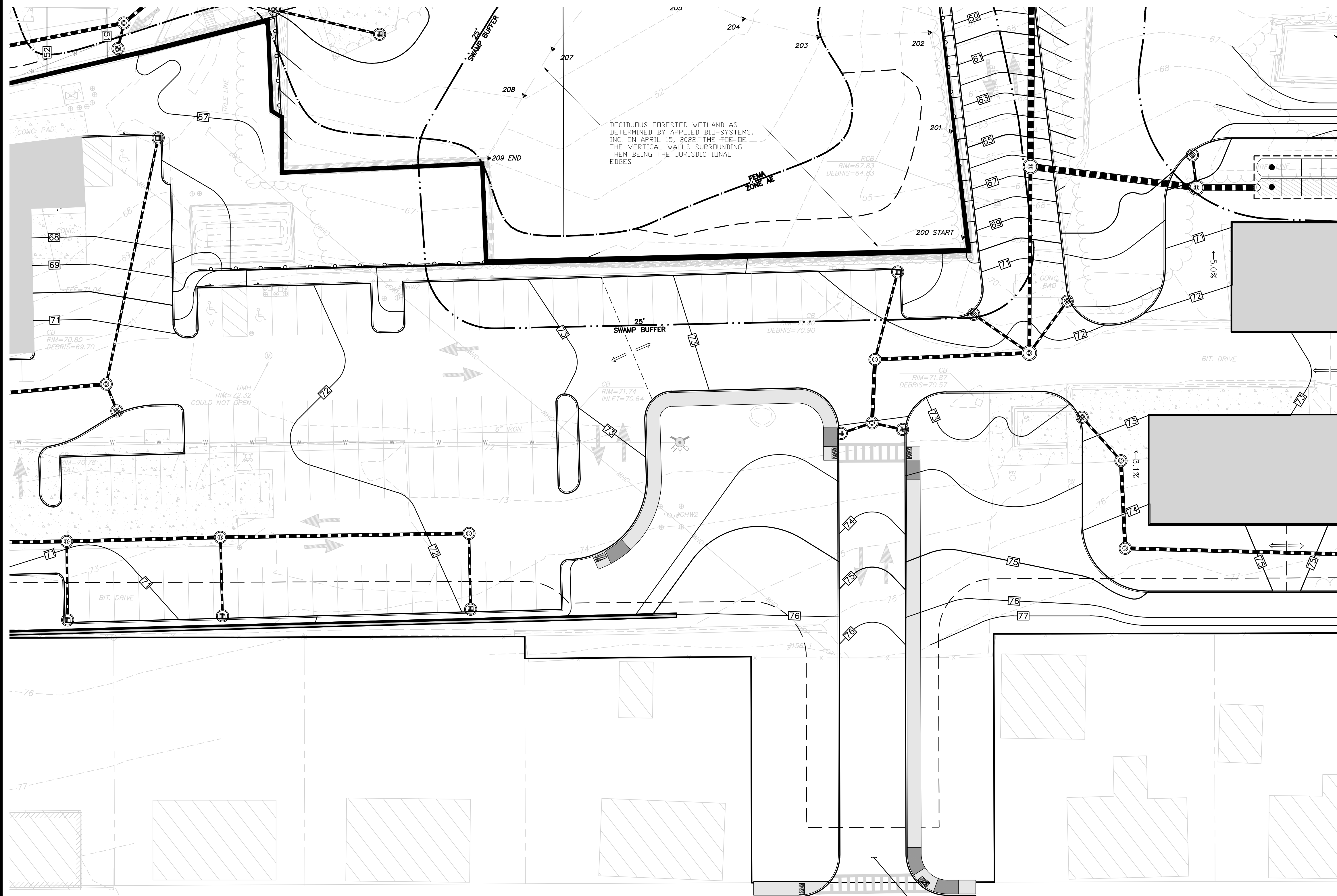

LEGEND

- DRAIN MANHOLE
- CATCH BASIN
- CATCH BASIN - DOUBLE GRATE
- OUTLET CONTROL
- DIVERSION WEIR
- WATER QUALITY UNIT
- AREA DRAIN
- FLARED END SECTION
- DRAIN LINE
- RIPRAP OUTFALL
- HEADWALL
- 5' CONTOUR
- 1' CONTOUR
- SPOT GRADE
- INFILTRATION SYSTEM
- INFILTRATION PIPE
- DETENTION PIPE
- UNDERDRAIN
- FLOW DIRECTION

- #### GENERAL NOTES:
- REFER TO SHEET C-102 FOR ADDITIONAL COMPLIANCE INFORMATION.
 - ALL CONSTRUCTION SHALL CONFORM TO THE APPLICABLE REGULATIONS AND STANDARDS INCLUDING THE TOWN OF CRANSTON, RIDOT, RIDEP, MUTCD, AND AASHTO.
 - THE CONTRACTOR IS SOLELY RESPONSIBLE FOR THE MEANS AND METHODS OF CONSTRUCTION AND FOR CONDITIONS AT THE SITE. THESE PLANS, PREPARED BY ALLEN & MAJOR ASSOCIATES DO NOT EXTEND TO OR INCLUDE SYSTEMS PERTAINING TO THE SAFETY OF THE CONSTRUCTION CONTRACTOR OR THEIR EMPLOYEES, AGENTS OR REPRESENTATIVES IN THE PERFORMANCE OF THE WORK, OR THE OWNER'S EMPLOYEES, CUSTOMERS, OR THE GENERAL PUBLIC. THE SEAL OF THE ENGINEER AS INCLUDED IN THE PLAN SET DOES NOT EXTEND TO ANY SUCH SAFETY SYSTEMS THAT MAY NOW OR HEREAFTER BE INCORPORATED INTO THESE PLANS. THE CONSTRUCTION CONTRACTOR SHALL PROVIDE THE APPROPRIATE SAFETY SYSTEMS WHICH MAY BE REQUIRED BY THE
 - ALL ELEVATIONS REFER TO NAVD 88.
 - THE CONTRACTOR SHALL ADHERE TO ALL TERMS & CONDITIONS AS OUTLINED IN THE GENERAL N.P.D.E.S. PERMIT FOR STORMWATER DISCHARGE ASSOCIATED WITH CONSTRUCTION ACTIVITIES.
 - IT IS THE RESPONSIBILITY OF THE CONTRACTOR TO REVIEW ALL DRAWINGS AND SPECIFICATIONS ASSOCIATED WITH THE PROJECT WORK SCOPE PRIOR TO THE START OF CONSTRUCTION. SHOULD THE CONTRACTOR FIND A CONFLICT WITH THE DRAWINGS, SPECIFICATIONS, OR RELATIVE CODES, IT IS THE RESPONSIBILITY OF THE CONTRACTOR TO NOTIFY THE ENGINEER AND/OR ARCHITECT PRIOR TO START OF CONSTRUCTION. FAILURE BY THE CONTRACTOR TO NOTIFY THE ENGINEER AND/OR ARCHITECT SHALL CONSTITUTE ACCEPTANCE OF FULL RESPONSIBILITY BY THE CONTRACTOR TO COMPLETE THE SCOPE OF WORK AND/OR DESIGN INTENT OF THE DRAWINGS AND IN FULL COMPLIANCE WITH LOCAL REGULATIONS AND CODES.
 - THE DESIGN ENGINEER WAIVES ANY AND ALL RESPONSIBILITY AND LIABILITY FOR PROBLEMS WHICH ARISE FROM FAILURE TO FOLLOW THESE PLANS, SPECIFICATIONS, AND/OR THE DESIGN INTENT THEY CONVEY, OR FOR PROBLEMS WHICH ARISE FROM OTHERS' FAILURE TO OBTAIN AND/OR FOLLOW THE GUIDANCE OF THE DESIGN ENGINEER WITH RESPECT TO ANY ERRORS, OMISSIONS, INCONSISTENCIES, AMBIGUITIES, OR CONFLICTS WHICH ARE DISCOVERED OR ALLEGED.

BRIAN D. JONES
No. 11089
REGISTERED PROFESSIONAL ENGINEER
CIVIL

Brian D. Jones
01-25-23

PROFESSIONAL ENGINEER FOR
ALLEN & MAJOR ASSOCIATES, INC.

REV	DATE	DESCRIPTION

APPLICANT/OWNER:
CPW TRUE STORAGE LLC
670 N. COMMERCIAL STREET, SUITE 303
MANCHESTER, NH 03101

PROJECT:
SITE REDEVELOPMENT
ASSESSORS MAP 8, LOTS 195, 1617 & 2711
1381 CRANSTON STREET - CRANSTON, RI

PROJECT NO.: 2038-08	DATE: 01-25-2023
SCALE: 1" = 20'	DWG.: C2038-08 GRADING & DRAINAGE
DESIGNED BY: JRG	CHECKED BY: MAM

ALLEN & MAJOR ASSOCIATES, INC.

civil engineering • land surveying
environmental consulting • landscape architecture
www.allenmajor.com
100 COMMERCE WAY, SUITE 5
WOBURN MA 01801
TEL: (781) 935-6889
FAX: (781) 935-2896

WOBURN, MA • LAKEVILLE, MA • MANCHESTER, NH

THIS DRAWING HAS BEEN PREPARED IN DIGITAL FORMAT. CLIENT/CLIENTS REPRESENTATIVE OR CONSULTANTS MAY BE PROVIDED COPIES OF DRAWINGS AND SPECIFICATIONS FOR HIS/HER INFORMATION AND/OR SPECIFIC USE ON THIS PROJECT. DUE TO THE POTENTIAL THAT THE PROVIDED INFORMATION MAY BE MODIFIED UNINTENTIONALLY OR OTHERWISE, ALLEN & MAJOR ASSOCIATES, INC. MAY REMOVE ALL INDICATION OF THE DOCUMENT'S AUTHORSHIP ON THE DIGITAL MEDIA. PRINTED REPRESENTATIONS OR PORTABLE DOCUMENT FORMAT OF THE DRAWINGS AND SPECIFICATIONS ISSUED SHALL BE THE ONLY RECORD COPIES OF ALLEN & MAJOR ASSOCIATES, INC.'S WORK PRODUCT.

DRAWING TITLE: GRADING & DRAINAGE PLAN
SHEET No.: C-103D

Copyright © 2022 Allen & Major Associates, Inc.
All Rights Reserved

R:\PROJECTS\2038-08\CIVIL\DRAWINGS\CURRENT\C-2038-08_GRADING & DRAINAGE.DWG

DIG SAFE

**BEFORE YOU DIG
CALL 811 OR
1-888-DIG-SAFE
1-888-344-7233**

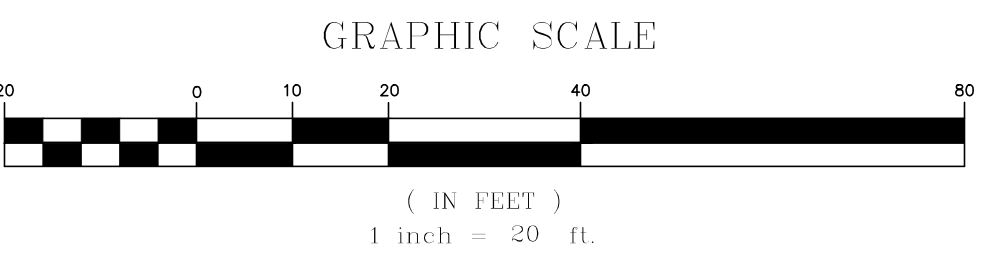

ADDITIONAL SURVEY REQUIRED

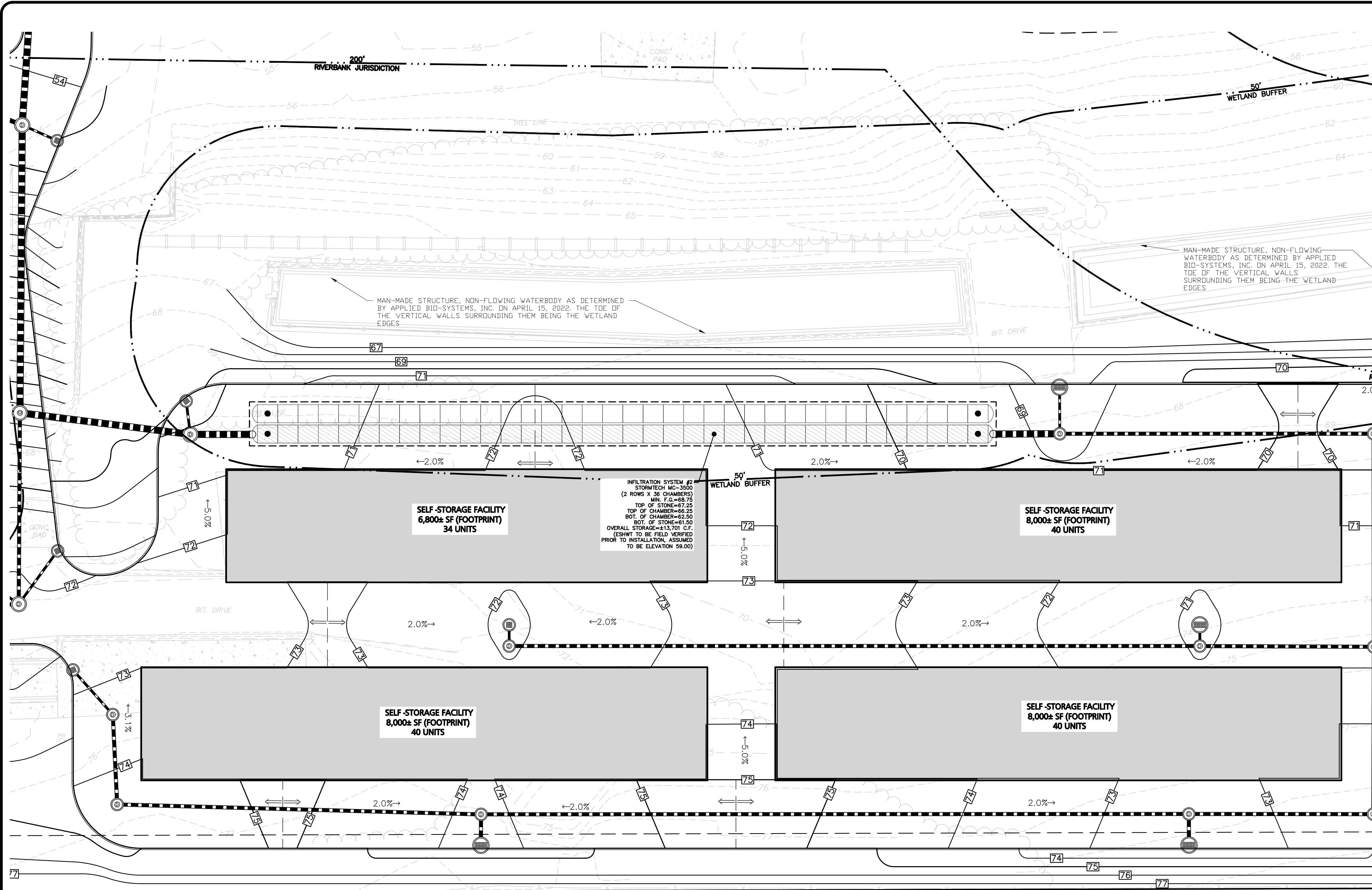

LEGEND

- DRAIN MANHOLE
- CATCH BASIN
- CATCH BASIN - DOUBLE GRATE
- OUTLET CONTROL
- DIVERSION WEIR
- WATER QUALITY UNIT
- AREA DRAIN
- FLARED END SECTION
- DRAIN LINE
- RIPRAP OUTFALL
- HEADWALL
- 5' CONTOUR
- 1' CONTOUR
- SPOT GRADE
- INFILTRATION SYSTEM
- INFILTRATION PIPE
- DETENTION PIPE
- UNDERDRAIN
- FLOW DIRECTION

- ### GENERAL NOTES:
- REFER TO SHEET C-102 FOR ADDITIONAL COMPLIANCE INFORMATION.
 - ALL CONSTRUCTION SHALL CONFORM TO THE APPLICABLE REGULATIONS AND STANDARDS INCLUDING THE TOWN OF CRANSTON, RIDOT, RIDEP, MUTCD, AND AASHTO.
 - THE CONTRACTOR IS SOLELY RESPONSIBLE FOR THE MEANS AND METHODS OF CONSTRUCTION AND FOR CONDITIONS AT THE SITE. THESE PLANS, PREPARED BY ALLEN & MAJOR ASSOCIATES DO NOT EXTEND TO OR INCLUDE SYSTEMS PERTAINING TO THE SAFETY OF THE CONSTRUCTION CONTRACTOR OR THEIR EMPLOYEES, AGENTS OR REPRESENTATIVES IN THE PERFORMANCE OF THE WORK, OR THE OWNER'S EMPLOYEES, CUSTOMERS, OR THE GENERAL PUBLIC. THE SEAL OF THE ENGINEER AS INCLUDED IN THE PLAN SET DOES NOT EXTEND TO ANY SUCH SAFETY SYSTEMS THAT MAY NOW OR HEREAFTER BE INCORPORATED INTO THESE PLANS. THE CONSTRUCTION CONTRACTOR SHALL PROVIDE THE APPROPRIATE SAFETY SYSTEMS WHICH MAY BE REQUIRED BY THE
 - ALL ELEVATIONS REFER TO NAVD 88.
 - THE CONTRACTOR SHALL ADHERE TO ALL TERMS & CONDITIONS AS OUTLINED IN THE GENERAL N.P.D.E.S. PERMIT FOR STORMWATER DISCHARGE ASSOCIATED WITH CONSTRUCTION ACTIVITIES.
 - IT IS THE RESPONSIBILITY OF THE CONTRACTOR TO REVIEW ALL DRAWINGS AND SPECIFICATIONS ASSOCIATED WITH THE PROJECT WORK SCOPE PRIOR TO THE START OF CONSTRUCTION. SHOULD THE CONTRACTOR FIND A CONFLICT WITH THE DRAWINGS, SPECIFICATIONS, OR RELATIVE CODES, IT IS THE RESPONSIBILITY OF THE CONTRACTOR TO NOTIFY THE ENGINEER AND/OR ARCHITECT PRIOR TO START OF CONSTRUCTION. FAILURE BY THE CONTRACTOR TO NOTIFY THE ENGINEER AND/OR ARCHITECT SHALL CONSTITUTE ACCEPTANCE OF FULL RESPONSIBILITY BY THE CONTRACTOR TO COMPLETE THE SCOPE OF WORK AND/OR DESIGN INTENT OF THE DRAWINGS AND IN FULL COMPLIANCE WITH LOCAL REGULATIONS AND CODES.
 - THE DESIGN ENGINEER WAIVES ANY AND ALL RESPONSIBILITY AND LIABILITY FOR PROBLEMS WHICH ARISE FROM FAILURE TO FOLLOW THESE PLANS, SPECIFICATIONS, AND/OR THE DESIGN INTENT THEY CONVEY, OR FOR PROBLEMS WHICH ARISE FROM OTHERS' FAILURE TO OBTAIN AND/OR FOLLOW THE GUIDANCE OF THE DESIGN ENGINEER WITH RESPECT TO ANY ERRORS, OMISSIONS, INCONSISTENCIES, AMBIGUITIES, OR CONFLICTS WHICH ARE DISCOVERED OR ALLEGED.

BRIAN D. JONES
No. 11089
REGISTERED PROFESSIONAL ENGINEER
CIVIL

Brian D. Jones
01-25-23

PROFESSIONAL ENGINEER FOR
ALLEN & MAJOR ASSOCIATES, INC.

REV	DATE	DESCRIPTION

APPLICANT/OWNER:
CPW TRUE STORAGE LLC
670 N. COMMERCIAL STREET, SUITE 303
MANCHESTER, NH 03101

PROJECT:
SITE REDEVELOPMENT
ASSESSORS MAP 8, LOTS 195, 1617 & 2711
1381 CRANSTON STREET - CRANSTON, RI

PROJECT NO.	2038-08	DATE:	01-25-2023
SCALE:	1" = 20'	DWG.:	C2038-08 GRADING & DRAINAGE
DESIGNED BY:	JRG	CHECKED BY:	MAM

PREPARED BY:

ALLEN & MAJOR ASSOCIATES, INC.
civil engineering • land surveying
environmental consulting • landscape architecture
www.allenmajor.com
100 COMMERCE WAY, SUITE 5
WOBBURN MA 01801
TEL: (781) 935-6889
FAX: (781) 935-2896

WOBBURN, MA • LAKEVILLE, MA • MANCHESTER, NH

THIS DRAWING HAS BEEN PREPARED IN DIGITAL FORMAT. CLIENT/CUSTOMER REPRESENTATIVE OR CONSULTANTS MAY BE PROVIDED COPIES OF DRAWINGS AND SPECIFICATIONS FOR HIS/HER INFORMATION AND/OR SPECIFIC USE ON THIS PROJECT. DUE TO THE POTENTIAL THAT THE PROVIDED INFORMATION MAY BE MODIFIED UNINTENTIONALLY OR OTHERWISE, ALLEN & MAJOR ASSOCIATES, INC. MAY REMOVE ALL INDICATION OF THE DOCUMENT'S AUTHORSHIP ON THE DIGITAL MEDIA. PRINTED REPRESENTATIONS OR PORTABLE DOCUMENT FORMAT OF THE DRAWINGS AND SPECIFICATIONS ISSUED SHALL BE THE ONLY RECORD COPIES OF ALLEN & MAJOR ASSOCIATES, INC.'S WORK PRODUCT.

DRAWING TITLE: GRADING & DRAINAGE PLAN C-103E
SHEET No. C-103E

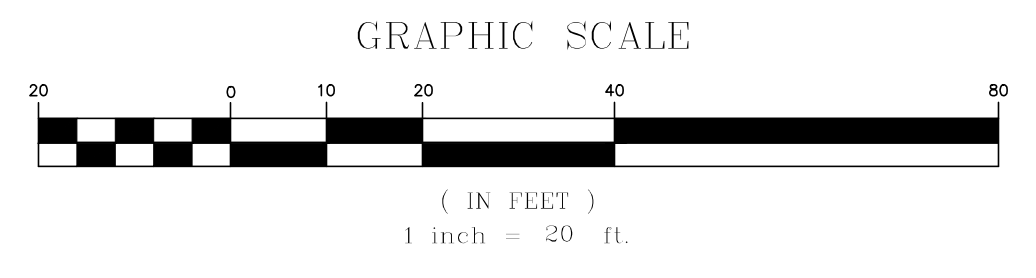

DIG SAFE
BEFORE YOU DIG
CALL 811 OR
1-888-DIG-SAFE
1-888-344-7233

R:\PROJECTS\2038-08\CIVIL\DRAWINGS\CURRENT\C-2038-08_GRADING & DRAINAGE.DWG

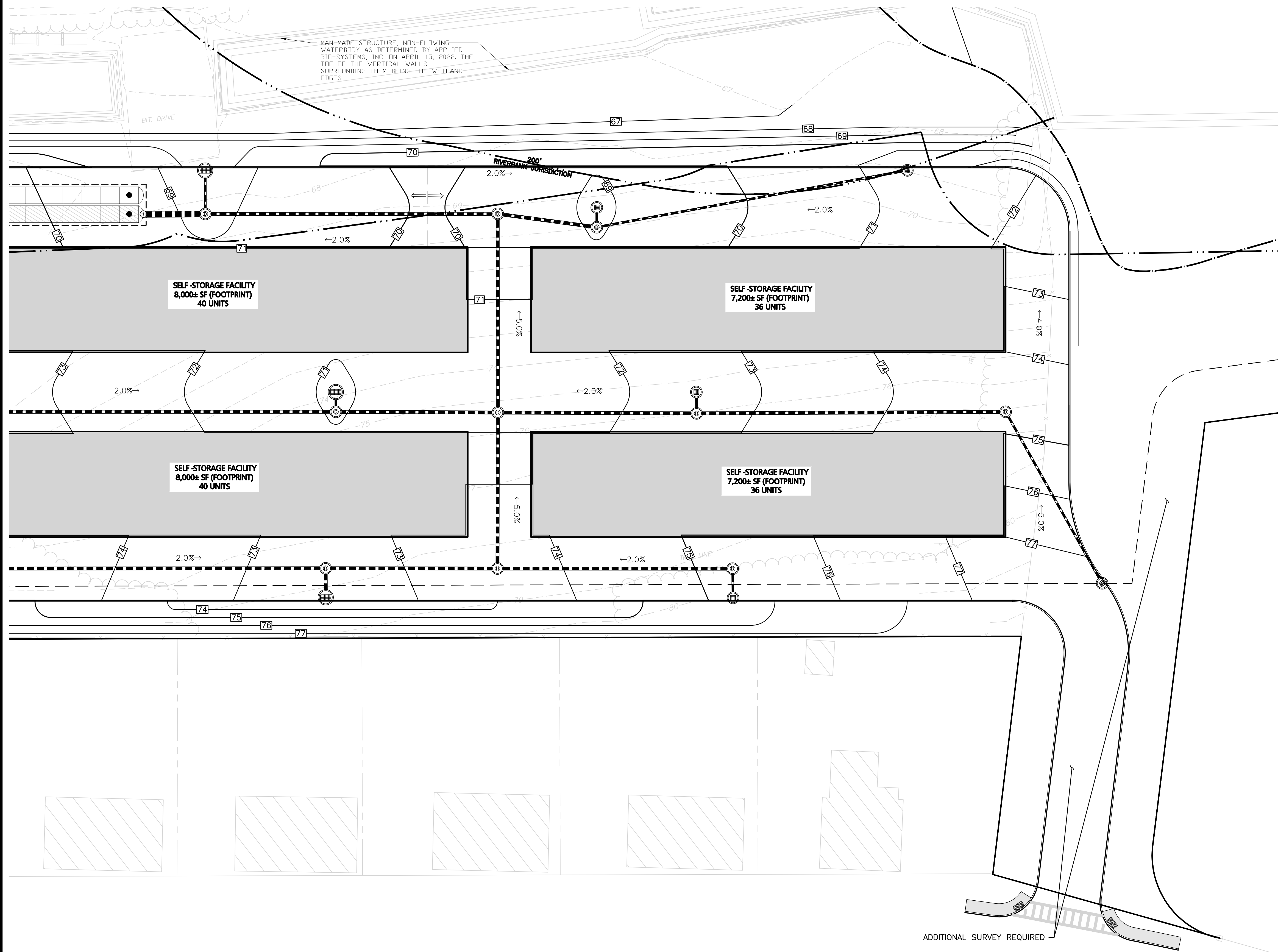

LEGEND

- DRAIN MANHOLE
- CATCH BASIN
- CATCH BASIN - DOUBLE GRATE
- OUTLET CONTROL
- DIVERSION WEIR
- WATER QUALITY UNIT
- AREA DRAIN
- FLARED END SECTION
- DRAIN LINE
- RIPRAP OUTFALL
- HEADWALL
- 5' CONTOUR
- 1' CONTOUR
- SPOT GRADE
- INFILTRATION SYSTEM
- INFILTRATION PIPE
- DETENTION PIPE
- UNDERDRAIN
- FLOW DIRECTION

- GENERAL NOTES:**
- REFER TO SHEET C-102 FOR ADDITIONAL COMPLIANCE INFORMATION.
 - ALL CONSTRUCTION SHALL CONFORM TO THE APPLICABLE REGULATIONS AND STANDARDS INCLUDING THE TOWN OF CRANSTON, RIDOT, RIDEP, MUTCD, AND AASHTO.
 - THE CONTRACTOR IS SOLELY RESPONSIBLE FOR THE MEANS AND METHODS OF CONSTRUCTION AND FOR CONDITIONS AT THE SITE. THESE PLANS, PREPARED BY ALLEN & MAJOR ASSOCIATES DO NOT EXTEND TO OR INCLUDE SYSTEMS PERTAINING TO THE SAFETY OF THE CONSTRUCTION CONTRACTOR OR THEIR EMPLOYEES, AGENTS OR REPRESENTATIVES IN THE PERFORMANCE OF THE WORK, OR THE OWNER'S EMPLOYEES, CUSTOMERS, OR THE GENERAL PUBLIC. THE SEAL OF THE ENGINEER AS INCLUDED IN THE PLAN SET DOES NOT EXTEND TO ANY SUCH SAFETY SYSTEMS THAT MAY NOW OR HEREAFTER BE INCORPORATED INTO THESE PLANS. THE CONSTRUCTION CONTRACTOR SHALL PROVIDE THE APPROPRIATE SAFETY SYSTEMS WHICH MAY BE REQUIRED BY THE
 - ALL ELEVATIONS REFER TO NAVD 88.
 - THE CONTRACTOR SHALL ADHERE TO ALL TERMS & CONDITIONS AS OUTLINED IN THE GENERAL N.P.D.E.S. PERMIT FOR STORMWATER DISCHARGE ASSOCIATED WITH CONSTRUCTION ACTIVITIES.
 - IT IS THE RESPONSIBILITY OF THE CONTRACTOR TO REVIEW ALL DRAWINGS AND SPECIFICATIONS ASSOCIATED WITH THE PROJECT WORK SCOPE PRIOR TO THE START OF CONSTRUCTION. SHOULD THE CONTRACTOR FIND A CONFLICT WITH THE DRAWINGS, SPECIFICATIONS, OR RELATIVE CODES, IT IS THE RESPONSIBILITY OF THE CONTRACTOR TO NOTIFY THE ENGINEER AND/OR ARCHITECT PRIOR TO START OF CONSTRUCTION. FAILURE BY THE CONTRACTOR TO NOTIFY THE ENGINEER AND/OR ARCHITECT SHALL CONSTITUTE ACCEPTANCE OF FULL RESPONSIBILITY BY THE CONTRACTOR TO COMPLETE THE SCOPE OF WORK AND/OR DESIGN INTENT OF THE DRAWINGS AND IN FULL COMPLIANCE WITH LOCAL REGULATIONS AND CODES.
 - THE DESIGN ENGINEER WAIVES ANY AND ALL RESPONSIBILITY AND LIABILITY FOR PROBLEMS WHICH ARISE FROM FAILURE TO FOLLOW THESE PLANS, SPECIFICATIONS, AND/OR THE DESIGN INTENT THEY CONVEY, OR FOR PROBLEMS WHICH ARISE FROM OTHERS' FAILURE TO OBTAIN AND/OR FOLLOW THE GUIDANCE OF THE DESIGN ENGINEER WITH RESPECT TO ANY ERRORS, OMISSIONS, INCONSISTENCIES, AMBIGUITIES, OR CONFLICTS WHICH ARE DISCOVERED OR ALLEGED.

BRIAN D. JONES
No. 11089
REGISTERED
PROFESSIONAL ENGINEER
CIVIL

Brian D. Jones
01-25-23

PROFESSIONAL ENGINEER FOR
ALLEN & MAJOR ASSOCIATES, INC.

REV	DATE	DESCRIPTION

APPLICANT/OWNER:
CPW TRUE STORAGE LLC
670 N. COMMERCIAL STREET, SUITE 303
MANCHESTER, NH 03101

PROJECT:
SITE REDEVELOPMENT
ASSESSORS MAP 8, LOTS 195, 1617 & 2711
1381 CRANSTON STREET - CRANSTON, RI

PROJECT NO. 2038-08	DATE: 01-25-2023
SCALE: 1" = 20'	DWG.: C2038-08 GRADING & DRAINAGE
DESIGNED BY: JRG	CHECKED BY: MAM

PREPARED BY:

ALLEN & MAJOR ASSOCIATES, INC.
civil engineering • land surveying
environmental consulting • landscape architecture
www.allenmajor.com
100 COMMERCE WAY, SUITE 5
WOBURN MA 01801
TEL: (781) 935-6889
FAX: (781) 935-2896

WOBURN, MA • LAKEVILLE, MA • MANCHESTER, NH

THIS DRAWING HAS BEEN PREPARED IN DIGITAL FORMAT. CLIENT/CUSTOMER REPRESENTATIVE OR CONSULTANTS MAY BE PROVIDED COPIES OF DRAWINGS AND SPECIFICATIONS FOR HIS/HER INFORMATION AND/OR SPECIFIC USE ON THIS PROJECT. DUE TO THE POTENTIAL THAT THE PROVIDED INFORMATION MAY BE MODIFIED UNINTENTIONALLY OR OTHERWISE, ALLEN & MAJOR ASSOCIATES, INC. MAY REMOVE ALL INDICATION OF THE DOCUMENT'S AUTHORSHIP ON THE DIGITAL MEDIA. PRINTED REPRESENTATIONS OR PORTABLE DOCUMENT FORMAT OF THE DRAWINGS AND SPECIFICATIONS ISSUED SHALL BE THE ONLY RECORD COPIES OF ALLEN & MAJOR ASSOCIATES, INC.'S WORK PRODUCT.

DRAWING TITLE:	SHEET No.
GRADING & DRAINAGE PLAN	C-103F

Copyright © 2022 Allen & Major Associates, Inc.
All Rights Reserved

ADDITIONAL SURVEY REQUIRED

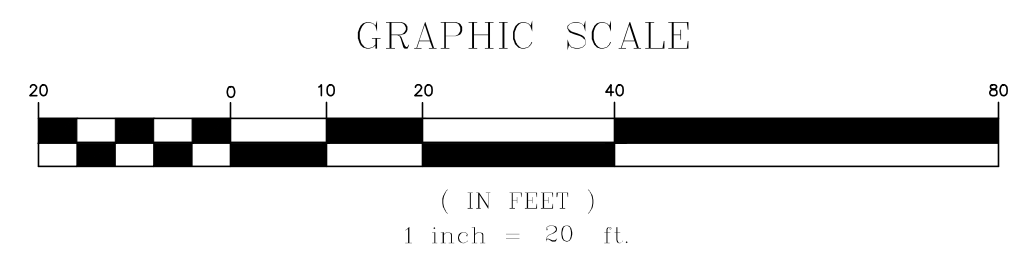

DIG SAFE

BEFORE YOU DIG
CALL 811 OR
1-888-DIG-SAFE
1-888-344-7233

R:\PROJECTS\2038-08\CIVIL\DRAWINGS\CURRENT\C-2038-08_GRADING & DRAINAGE.DWG